

# MVSI 12 ELECTRIC VIBRATOR SERIES

three-phase

6 poles		
Hz	50	60
RPM	1000	1200



DESCRIPTION						MECHANICAL FEATURES						ELECTRICAL FEATURES			
Part Number	Model	Design	Frame Size	SEB	Ex IICD Temp. Class	Static Moment* in-lbs		Centrifugal Force lbs		Weight lbs		Power Output HP		Max Current A	
						50 Hz	60 Hz	50 Hz	60 Hz	50 Hz	60 Hz	50 Hz	60 Hz	400 V 50 Hz	460 V 60 Hz
602296	MVSI 12-110	S02	10	•	120°C	2.62	2.62	77	108	21.3	21.3	0.07	0.12	0.30	0.30
602297	MVSI 12-300	S02	10	•	120°C	7.32	7.32	207	299	27.5	27.5	0.07	0.12	0.30	0.30
602298	MVSI 12-580	S02	20	•	120°C	14.2	14.2	403	581	41.8	41.8	0.13	0.16	0.50	0.50
602314	MVSI 12-760	S02	30	•	120°C	24.9	18.2	706	744	60.5	57.6	0.29	0.36	0.72	0.68
602402	MVSI 12-1630	S02	35	•	120°C	39.7	39.7	1126	1621	80.3	80.3	0.32	0.36	0.75	0.68
602403	MVSI 12-1660	S02	35	•	120°C	50.4	39.7	1430	1621	90.2	80.3	0.32	0.36	0.75	0.68
602380	MVSI 12-1990	S08	40	•	135°C	62.9	48.8	1780	1991	106	96.8	0.60	0.69	1.40	1.35
602381	MVSI 12-2540	S08	50	•	135°C	88.0	62.2	2490	2532	128	112	0.74	0.75	1.65	1.50
602382	MVSI 12-3110	S08	50	•	170°C	111	80.1	3133	3263	145	131	0.87	0.87	1.80	1.70
602406	MVSI 12-3410	S08	60	•	135°C	127	83.6	3604	3408	183	156	1.1	1.3	2.20	2.20
602407	MVSI 12-4700	S08	60	•	200°C	168	115	4739	4624	205	180	1.5	1.6	3.00	2.75
602167	MVSI 12-6050	S02	70	•	135°C	202	150	5722	6043	286	255	2.1	2.3	4.10	3.75
602230	MVSI 12-6600	S02	70	•	135°C	234	169	6615	6873	319	286	2.3	2.7	4.50	4.30
602154	MVSI 12-8450	S02	80	•	135°C	298	207	8417	8428	414	374	2.6	3.1	5.10	5.00
602204	MVSI 12-10400	S02	80	•	135°C	366	251	10342	10226	449	403	3.5	3.9	6.50	6.00
602350	MVSI 12-11400	S02	80	•	135°C	407	281	11506	11440	495	440	3.5	3.9	6.50	6.00
602138	MVSI 12-11700	S02	90	•	135°C	405	286	11458	11645	524	473	3.9	4.2	7.00	6.50
602351	MVSI 12-12300	S02	90	•	135°C	439	302	12430	12320	528	484	3.9	4.2	7.00	6.50
602091	MVSI 12-14400	S02	90	•	135°C	508	353	14359	14364	590	568	4.3	4.7	8.20	8.10
602136	MVSI 12-14500	S02	97	•	135°C	529	346	14958	14091	627	565	5.6	6.7	10.0	9.80
602352	MVSI 12-15400	S02	90	•	135°C	545	378	15429	15400	605	579	4.3	4.7	8.20	8.10
602092	MVSI 12-17600	S90	95	°	135°C	626	432	17701	17591	693	609	7.5	8.4	12.6	11.3
602093	MVSI 12-19100	S90	95	°	135°C	674	468	19065	19072	717	636	8.0	9.4	14.0	12.9
602137	MVSI 12-20100	S02	97	°	135°C	754	492	21329	20057	838	748	8.4	9.0	13.5	12.4
602349	MVSI 12-24400	S02	97	°	135°C	868	600	24552	24420	891	814	8.4	9.0	13.5	12.4
602134	MVSI 12-26500	S90	100	°	135°C	956	656	27047	26710	1100	979	10.1	11.0	16.3	15.0
602227	MVSI 12-29000	S02	97	°	135°C	1001	709	28307	28886	1012	840	10.6	11.4	17.0	16.0
602142	MVSI 12-31000	S02	105	°	135°C	1101	756	31141	30809	1415	1331	12.1	13.4	19.0	18.0
602143	MVSI 12-37000	S02	105	°	135°C	1348	908	38119	36969	1551	1443	14.7	15.4	24.5	23.0
602244	MVSI 12-40000	S02	105	°	135°C	1560	994	44136	40480	1564	1454	15.8	16.6	25.5	24.0
602144	MVSI 12-45000	S90	110	°	135°C	1741	1090	49249	44458	2037	1971	20.6	20.4	33.0	25.5
602273	MVSI 12-55000	S90	110	°	135°C	1945	1286	55000	52360	2112	2042	20.6	20.4	33.0	25.5

-  ° CSA Approval available if factory wired.
-  CSA Approval for Class I, Division 2, Groups A, B, C and D hazardous locations. Available upon request.
-  Product approved for European Directive 94/9/EC (EN 61241-0, EN 61241-1): ATEX II2D, tD A21 IP66 (temperature class detailed in table).
-  All listed products are in compliance with GOST R 51330.0-99, GOST R 51330.1, GOST R 51330.8-99, GOST R IEC 61241-1-1-99.
-  Product approved for IECEx Scheme following IEC 61241-0, 61241-1: II2D, tD A21 IP66 (Temperature class detailed in table).
-  In compliance with all applicable European Directives.

Working Moment = 2 x Static Moment. Static Moment = Unbalance.  
For 230 V, 60 Hz amperage, double the 460 V, 60 Hz amperage.

# MVSI 12 ELECTRIC VIBRATOR SERIES

## three-phase

6 poles		
Hz	50	60
RPM	1000	1200



### OVERALL DIMENSIONS (inches)

Model	Design	Type	OVERALL DIMENSIONS (inches)												
			A	B	C	D	E	Foot holes øG N°		F	H	I	L	M	N
MVSI 12-110	S02	A	10.04	7.05	5.98	3.54	4.92	0.51	4	1.10	2.87	2.13	5.00	5.04	5.55
MVSI 12-300	S02	A	11.85	7.05	5.98	3.54	4.92	0.51	4	1.10	2.87	3.03	5.00	5.04	5.55
MVSI 12-580	S02	A	13.54	7.99	6.57	4.13	5.51	0.51	4	1.18	3.25	3.66	5.71	5.51	6.30
MVSI 12-760	S02	A	15.51	8.50	8.07	4.72	6.69	0.67	4	1.77	3.68	4.17	6.69	6.30	7.17
MVSI 12-1630	S02	A	17.13	8.86	8.07	4.72	6.69	0.67	4	2.13	4.11	4.63	7.36	6.38	7.99
MVSI 12-1660	S02	A	18.90(50Hz) 17.13(60Hz)	8.86	8.07	4.72	6.69	0.67	4	2.13	4.11	5.51(50Hz) 4.63(60Hz)	7.36	6.38	7.99
MVSI 12-1990	S08	A	26.22(50Hz) 22.99(60Hz)	9.69	9.06	5.51	7.48	0.67	4	2.13	4.57	5.28(50Hz) 4.25(60Hz)	8.15	7.48	8.86
MVSI 12-2540	S08	A	22.60	9.69	9.06	5.51	7.48	0.67	4	2.13	4.57	6.73	8.15	7.48	8.86
MVSI 12-3110	S08	A	22.60	9.69	9.06	5.51	7.48	0.67	4	2.13	4.57	6.73	8.15	7.48	8.86
MVSI 12-3410	S08	A	24.29(50Hz) 21.14(60Hz)	10.71	10.83	6.10	8.86	0.87	4	2.76	5.12	6.97(50Hz) 5.39(60Hz)	9.37	8.27	9.96
MVSI 12-4700	S08	A	24.29	10.71	10.83	6.10	8.86	0.87	4	2.76	5.12	6.97	9.37	8.27	9.96
MVSI 12-6050	S02	A	26.22	12.64	12.20	6.10	10.04	0.93	4	3.03	6.18	7.01	10.91	8.46	11.61
MVSI 12-6600	S02	A	28.03	12.64	12.20	6.10	10.04	0.93	4	3.03	6.18	7.91	10.91	8.46	11.61
MVSI 12-8450	S02	A	28.90	13.66	13.39	7.09	11.02	1.02	4	3.15	6.50	7.95	11.93	9.45	12.60
MVSI 12-10400	S02	A	31.34	13.66	13.39	7.09	11.02	1.02	4	3.15	6.50	9.17	11.93	9.45	12.60
MVSI 12-11400	S02	A	32.52	13.66	13.39	7.09	11.02	1.02	4	3.15	6.50	9.76	11.93	9.45	12.60
MVSI 12-11700	S02	A	29.29	14.57	15.35	7.87	12.60	1.10	4	3.54	7.09	7.56	12.99	10.63	13.78
MVSI 12-12300	S02	A	33.07	14.57	15.35	7.87	12.60	1.10	4	3.54	7.09	9.45	12.99	10.63	13.78
MVSI 12-14400	S02	A	33.07	14.57	15.35	7.87	12.60	1.10	4	3.54	7.09	9.45	12.99	10.63	13.78
MVSI 12-14500	S02	C	29.53	17.20	18.11	4.92	14.96	1.54	6	1.38	8.46	6.85	15.24	12.60	16.30
MVSI 12-15400	S02	A	33.07	14.57	15.35	7.87	12.60	1.10	4	3.54	7.09	9.45	12.99	10.63	13.78
MVSI 12-17600	S90	A	34.25	15.55	15.43	7.87	12.60	1.10	4	3.94	7.56	10.04	13.98	10.63	14.76
MVSI 12-19100	S90	A	34.25	15.55	15.43	7.87	12.60	1.10	4	3.94	7.56	10.04	13.98	10.63	14.76
MVSI 12-20100	S02	C	33.94	17.20	18.11	4.92	14.96	1.54	6	1.38	8.46	9.06	15.24	12.60	16.30
MVSI 12-24400	S02	C	35.91	17.20	18.11	4.92	14.96	1.54	6	1.38	8.46	10.04	15.24	12.60	16.30
MVSI 12-26500	S90	C	38.98	17.87	20.87	5.51	17.32	1.77	6	1.50	9.06	9.45	16.65	14.57	17.64
MVSI 12-29000	S02	C	39.45	17.20	18.11	4.92	14.96	1.54	6	1.38	8.46	11.81	15.24	12.60	16.30
MVSI 12-31000	S02	F	37.80	20.71	22.44	5.51	18.90	1.77	8	1.61	10.55	7.87	19.13	20.08	20.31
MVSI 12-37000	S02	F	40.94	20.71	22.44	5.51	18.90	1.77	8	1.61	10.55	9.45	19.13	20.08	20.31
MVSI 12-40000	S02	F	44.09	20.71	22.44	5.51	18.90	1.77	8	1.61	10.55	11.02	19.13	20.08	20.31
MVSI 12-45000	S90	F	45.28	23.90	24.02	5.51	20.47	1.77	8	1.50	11.69	11.71	21.34	20.08	22.91
MVSI 12-55000	S90	F	45.28	23.90	24.02	5.51	20.47	1.77	8	1.50	11.69	11.71	21.34	20.08	22.91

Type A

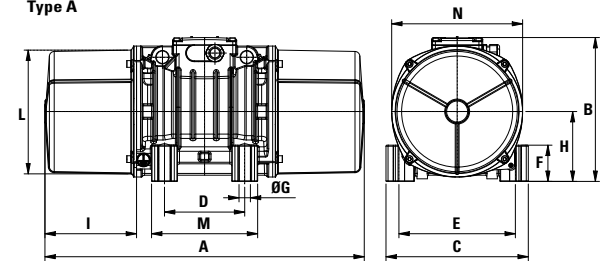

Type C

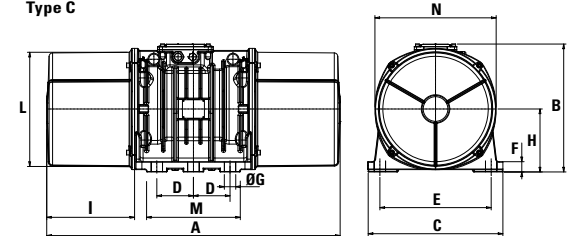

Type F

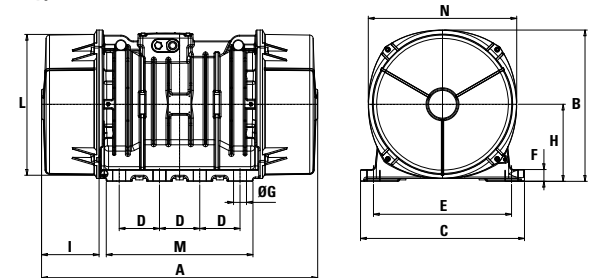

Several sizes are available with different mounting bolt patterns..